

BT9922

FULL SERVICE HEAVY DUTY WALL MOUNT FOR XXL DISPLAYS

The BT9922 is a dual rail, pop-out wall mount solution designed for extra-large signage displays such as the LG LAEC015. Capable of supporting heavy loads, the BT9922 is ideal for recess mounting and features a pop-out system for full service access, micro-adjustment for screen alignment and integrated cable management to help keep the finished installation tidy. Safety screws also help to prevent unauthorised removal of the screen.

SPECIFICATIONS

Recommended screen size	120" up to 136"
Max load	200kg
VESA® & non-VESA fixings	up to 2400 x 1200
Flat to wall depth	182.5mm (+/-7mm with micro-adjustment)
Popped out depth	374.5mm (+/-7mm with micro-adjustment)
Screen height adjustment	+/-14mm per corner

FEATURES

- Designed to wall mount extra-large signage displays such as LG LAEC015
- 1 Pop-out system provides safe and easy service access
- 2 Tool-less micro-adjustment of +/-7mm
- 3 Simple 'hook-on' installation
- 4 Integrated cable management clips included (BT8390-CMC)
- Features depth, height and lateral micro-adjustment
- Keyhole fixings on wall plates for an easier installation
- Safety screws help prevent unauthorised removal of screens
- Ideal for recess mounting
- All mounting hardware included
- Locking kit prevents accidental pop-out of the mount

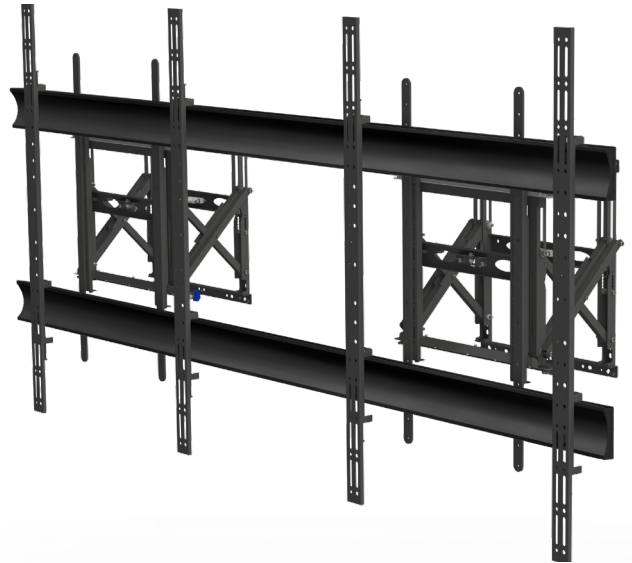

RECOMMENDED MAX SCREEN	MAX LOAD	MAX VESA	MICRO ADJUSTMENT	POST INSTALL ALIGNMENT	
136" 345cm	200kg	2400 x 1200			

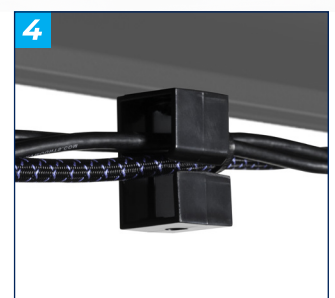
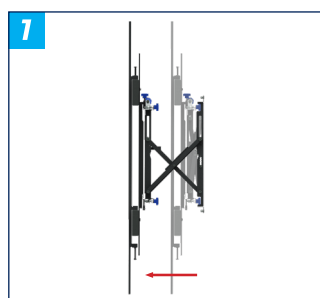

BT9922

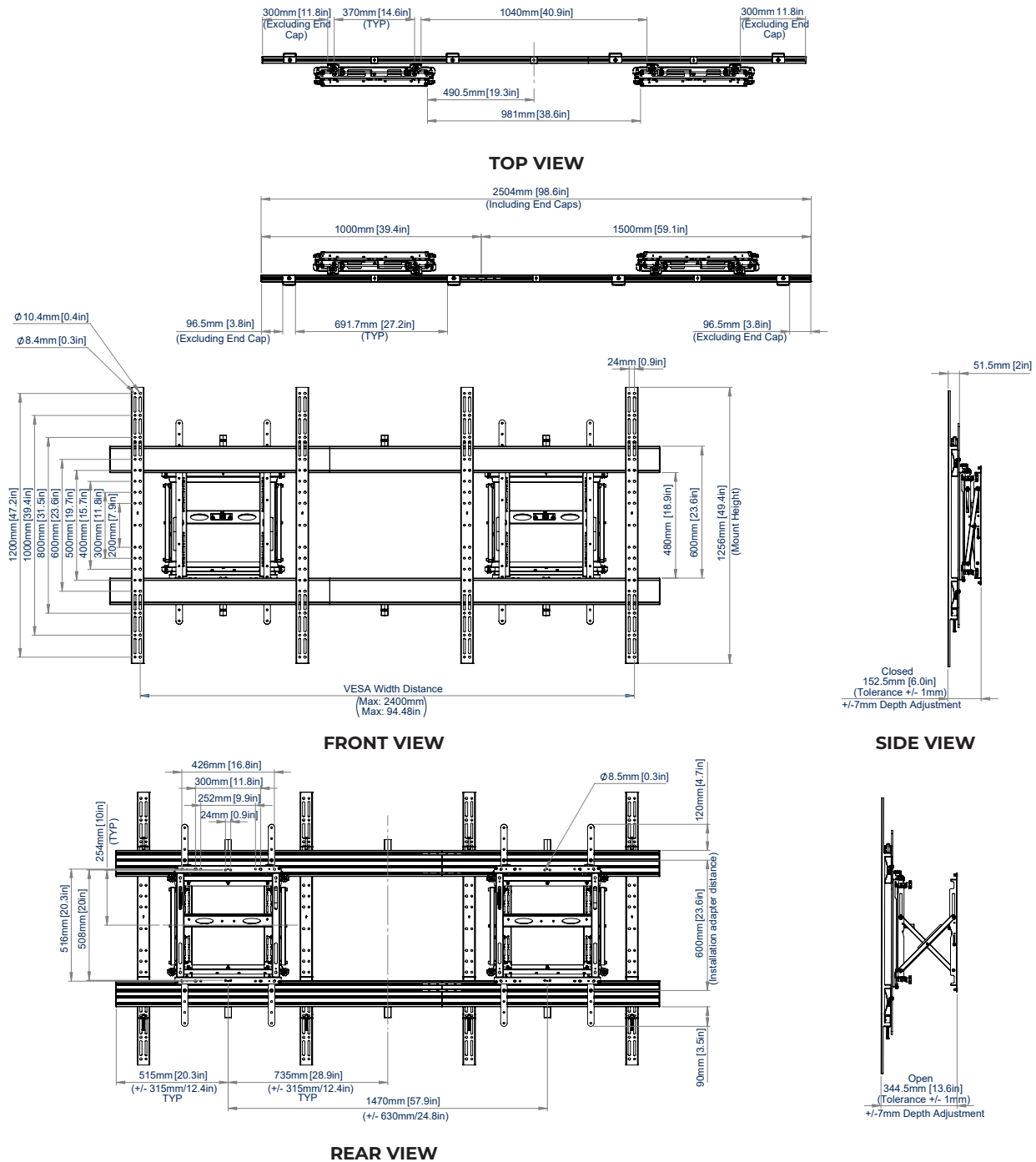

ORDERING INFORMATION

COLOUR	ORDER REF	EAN
Black	BT9922/B	5019318307539

RELATED PRODUCTS

PRODUCT CODE	NAME	DESCRIPTION
BT9920	XXL Wall Mount	For screens up to 120" and 200kg
BT9921	Soft-Open Full Service Wall Mount	For LG® 110UM5J-B
BT9925	Soft-Open Full Service Portrait Wall Mount	For LG® 110UM5J-B
BT8312	Heavy Duty Pop-Out Flat Screen Wall Mount	Suitable for mounting XL screens up to 120"