

SAFETY INFORMATION

Before you use this TW AUDIO product, read the manual carefully.

Loudspeakers can be checked and stamped according to BGV C1 by official departments. For more information contact TW AUDIO at info@twaudio.com or +49 (0) 71 41 - 48 89 89 0

GENERAL

The B10 is designed as a bass-reflex subwoofer, equipped with single 10" dual coil cone-driver. In addition the B10P is equipped with our intelligent passive crossover PWB10 which enables different operation modes.

B10 as default is available in black colour and warnex structure paint. Any different RAL color can be requested.

PWB10 (passive crossover module) is designed to be operated in two different modes:

- **MODE1: STEREO** - dual coil 10" driver (2 x 16 Ohm) is powered from two amplifier channels. Passive top loudspeakers can be connected to high-pass filtered TOP OUTPUTS driven by the same amplifier channels.

- **MODE2: MONO** - dual coil 10" driver (coils connected in parallel 1x 8 Ohm) is powered from one amplifier channel. Passive top loudspeakers can be connected to high-pass filtered TOP OUTPUTS driven by the same amplifier channel.

B10P can be used with any linear amplifier available on the market. TW AUDIO recommends dedicated system amplifiers like Powersoft K-Series, M-Series or LAB.GRUPPEN PLM- / D-Series and IPD-Series and offers dedicated presets for those.

B10 can only be groundstacked. There is no hardware available to fly this subwoofer. Find more on www.twaudio.de website.

If you have any questions about your product don't hesitate to contact TW AUDIO on support@twaudio.com or by phone +49 (0) 71 41 - 48 89 89 0.

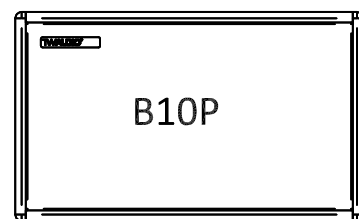

B10P		TECHNICAL DATA	
Frequency range	[Hz]	40 - 250 (without processing)	
Power pgm/peak	[W]	700 / 1400	
Impedance	[Ohm]	2 x 16 STEREO / 1 x 8 MONO	
Dispersion		omni	
Sensitivity	[dB]	91	
max SPL	[dB]	123	
Dimensions	[mm]	304 x 500 x 440	
Weight	[kg]	20,1	

FIG 1. CONNECTION TO AMPLIFIER with one FOUR WIRE CABLE

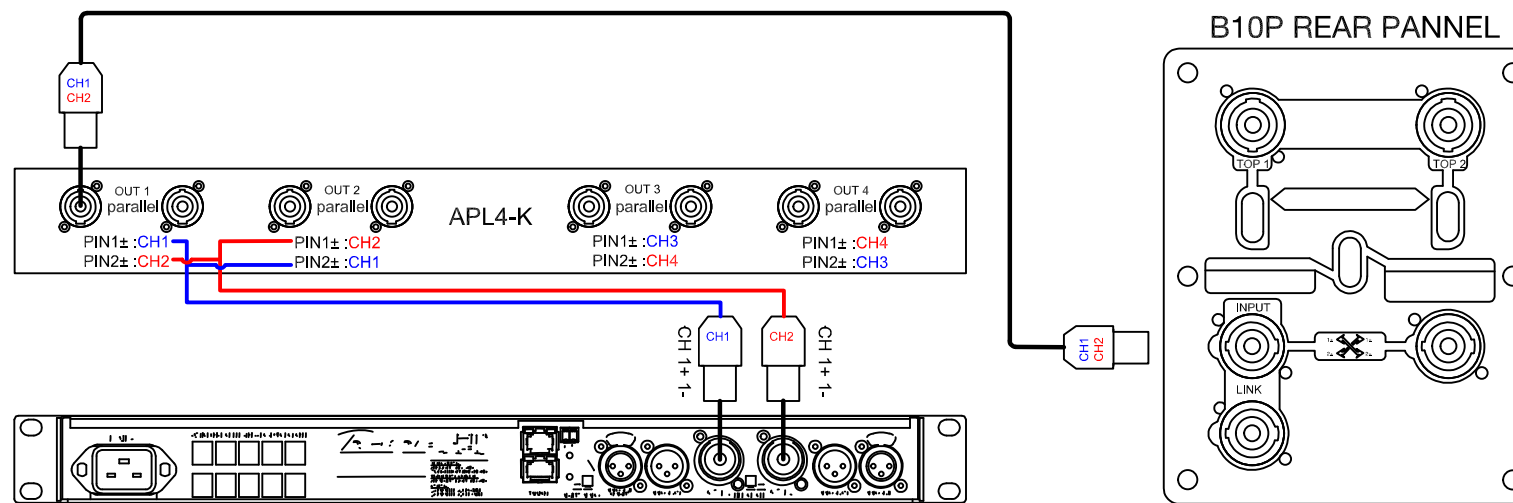

FIG 2. CONNECTION TO AMPLIFIER with two TWO WIRE CABLES

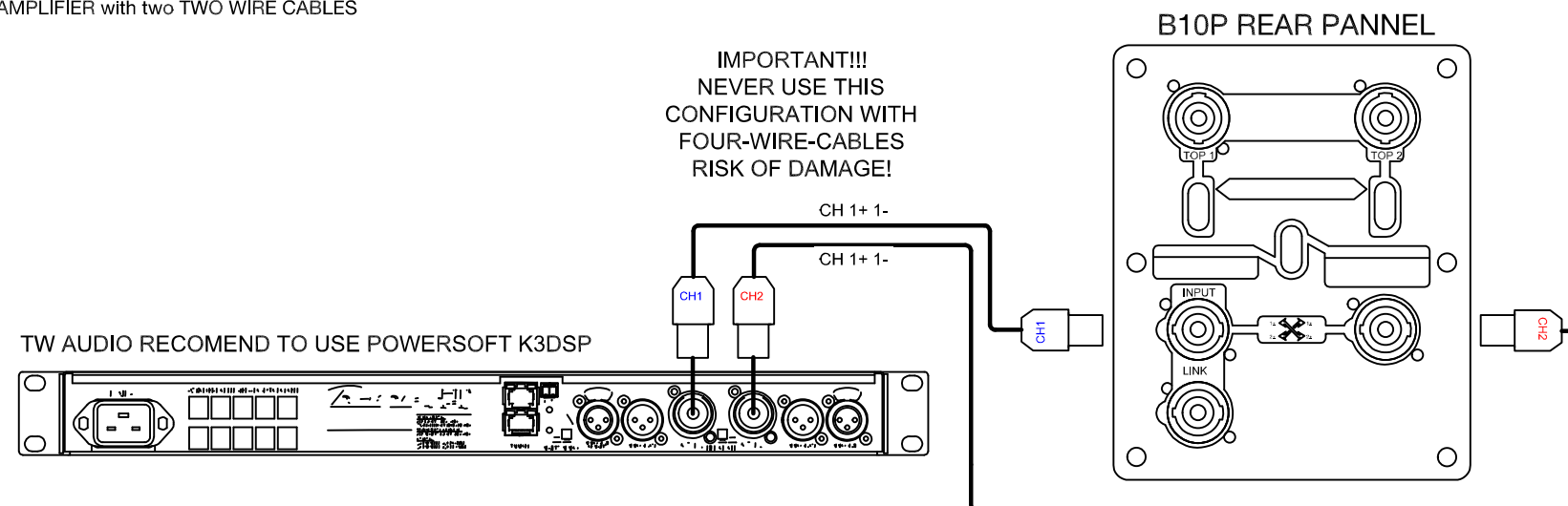
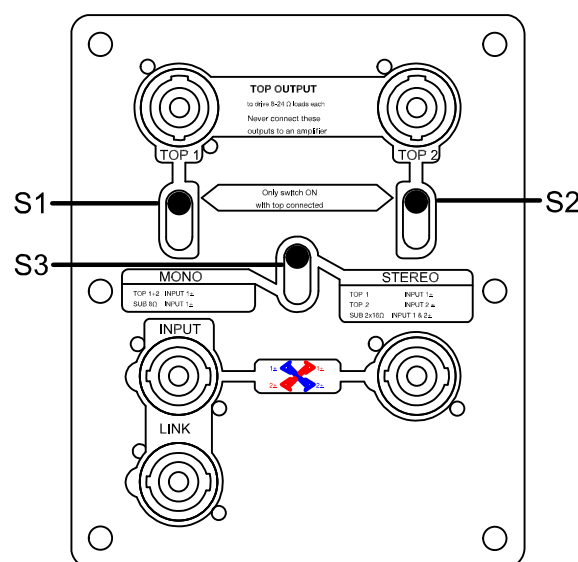

FIG 2. B10P REAR PANNEL AND CROSSOVER DIAGRAM



S1: TOP1 ON /TOP1 OFF
 - If you connect a top speaker to TOP1 output set SWITCH1 ON
 - If you don't connect any speaker to TOP1 output set SWITCH1 OFF

S2: TOP2 ON /TOP2 OFF
 - If you connect top speaker to TOP2 output set SWITCH1 ON
 - If you don't connect the speaker to TOP2 output set SWITCH1 OFF

S3: STEREO / MONO MODE

In STEREO MODE dual coil 10" speaker is powered from CH1 and CH2 of amplifier. You can use both TOP OUTPUTS.

In MONO MODE one channel of amplifier is required. Dual coil 10" speaker is powered parallel from one channel. You can use both TOP OUTPUTS.

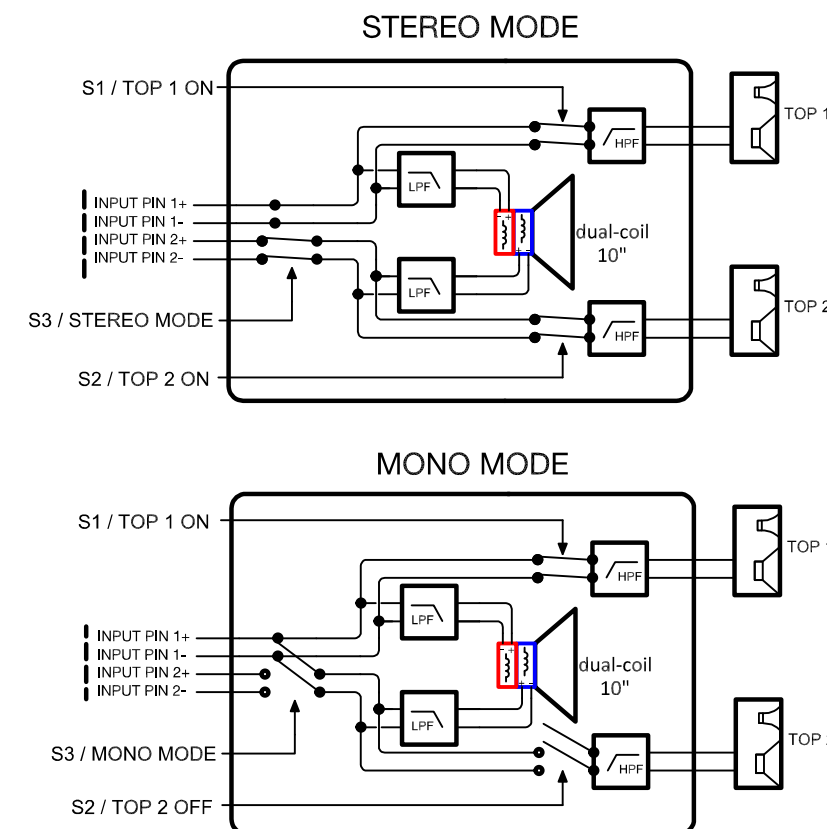
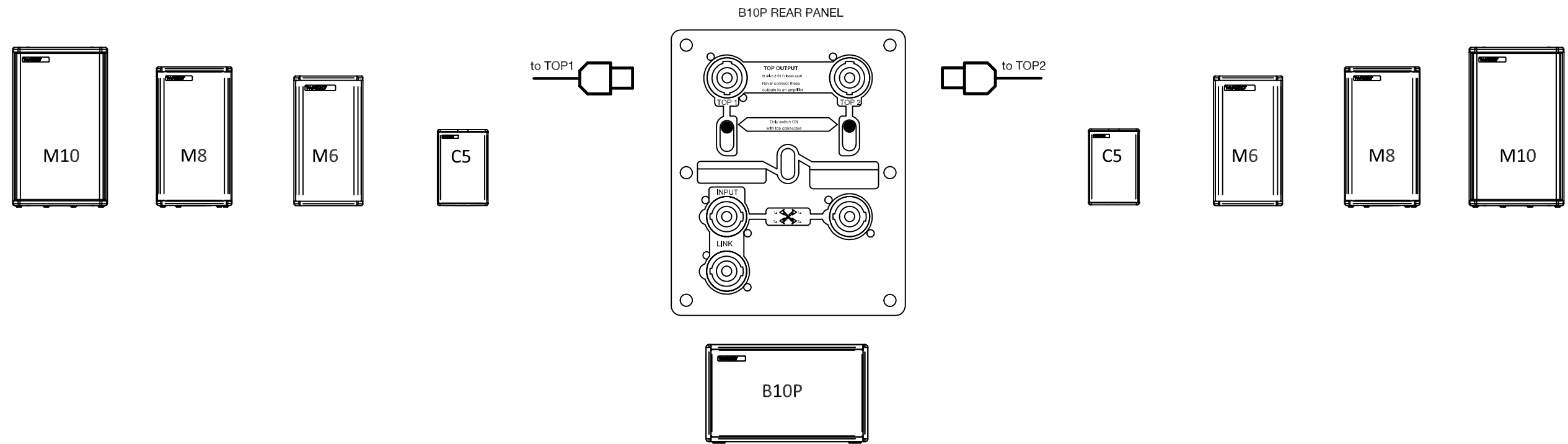
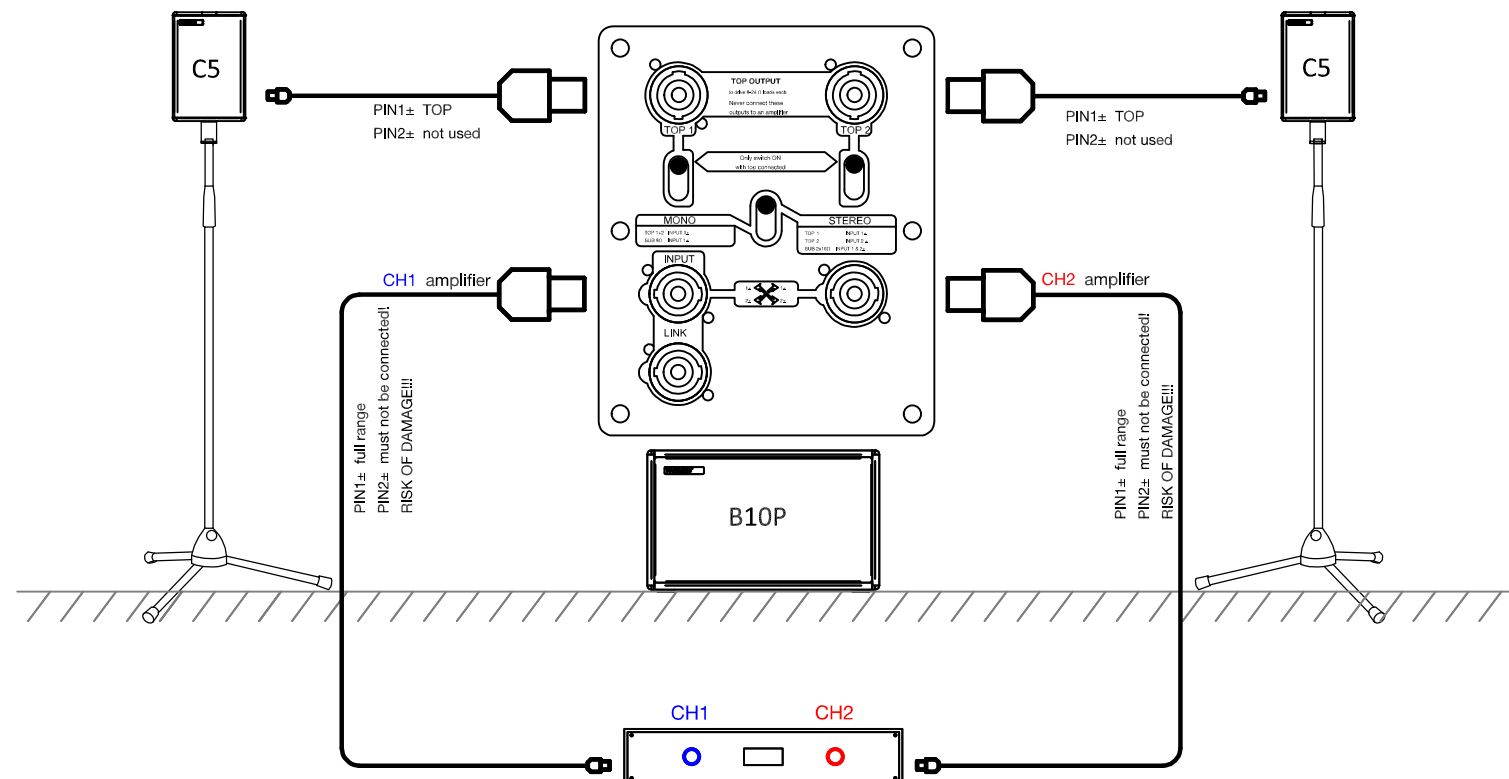

FIG 3. B10P TOP SPEAKERS COMBINATIONS



1x B10P (STEREO) + 2x C5

B10 equipped with PWB10 x-over



2x B10P (MONO) + 2x M8

B10 equipped with PWB10 x-over

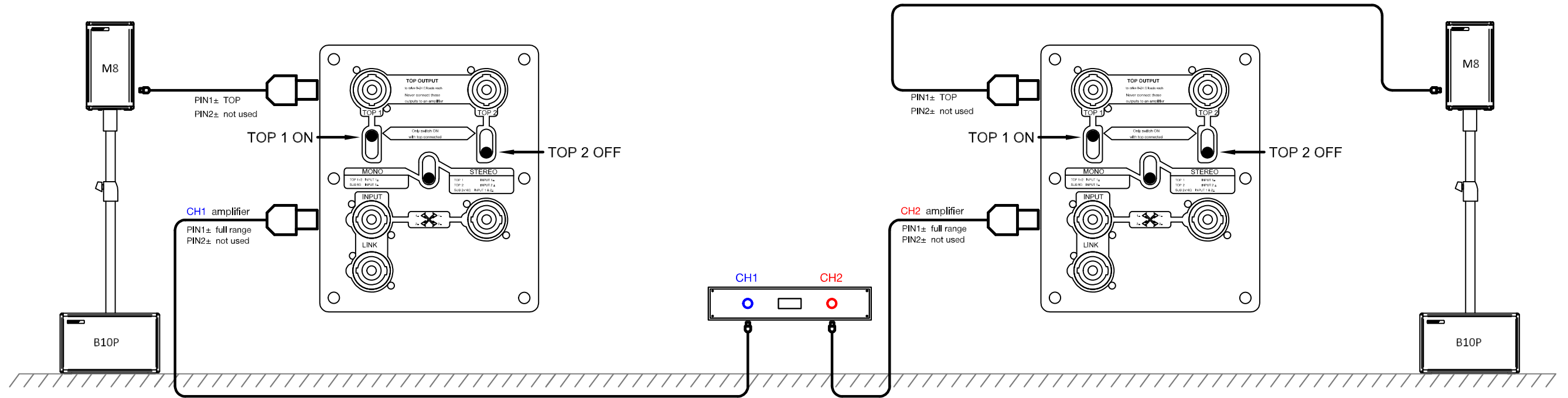

2x B10P (MONO) + 4x C5

B10 equipped with PWB10 x-over

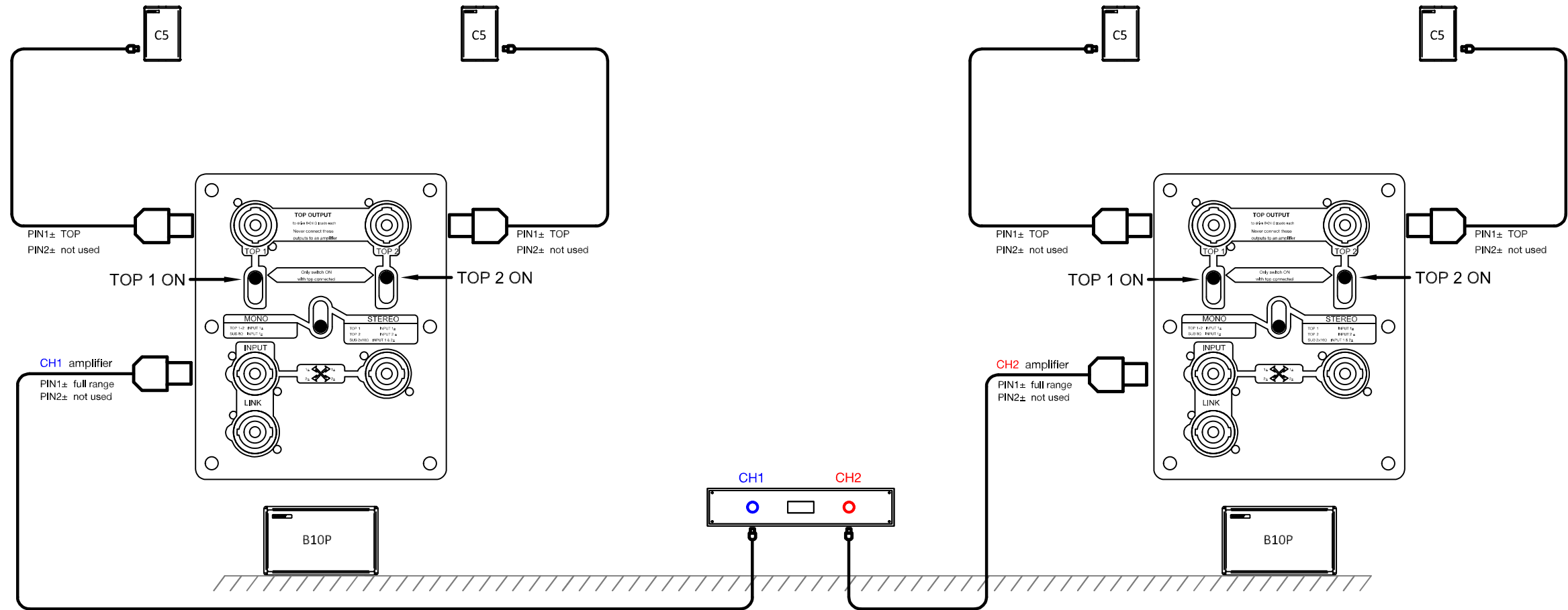

4x B10P (MONO) + 2x M10

B10 equipped with PWB10 x-over

